



## 5 Ellenborough Drive COORANBONG NSW

4 2 5

Located in the exclusive Ellenborough Park Estate amongst the Jacaranda trees lies an exquisite family home, perfectly designed as an escape from the hustle and bustle of life, providing an opportunity to soak up the semi-rural lifestyle this community has to offer. Brilliantly positioned on the high side of the street in this prestigious gated community, the immaculate, executive home presents as new and seamlessly marries indoor and outdoor living.

Set on a large 1600m<sup>2</sup> block, the impressive floorplan features four bedrooms plus a study, a large master with full bathroom-sized ensuite and multiple living areas, providing space and privacy for all. There's a stunning central kitchen; the hub of the home, a collection of outdoor alfresco spaces and a sparkling saltwater pool. In addition to the double garage, there's that sought-after drive

**Type** : House  
**Land Size** : 1600 sqm  
**View** : <https://www.wilsonbritten.com/sale/nsw/lake-macquarie-west/cooranbong/residential/home/8474013>



**Tom Gregg**  
02 4970 5545

[For full version visit the website](https://www.wilsonbritten.com)



Scale in metres Indicative only. Dimensions are approximate. All information contained herein is gathered from sources we believe to be reliable. However we cannot guarantee its accuracy and interested persons should rely on their own enquiries

INT : 261m<sup>2</sup>  
 GARAGE : 32m<sup>2</sup>

5 Ellenborough Drive, Cooranbong

**WILSONBRITTEN**

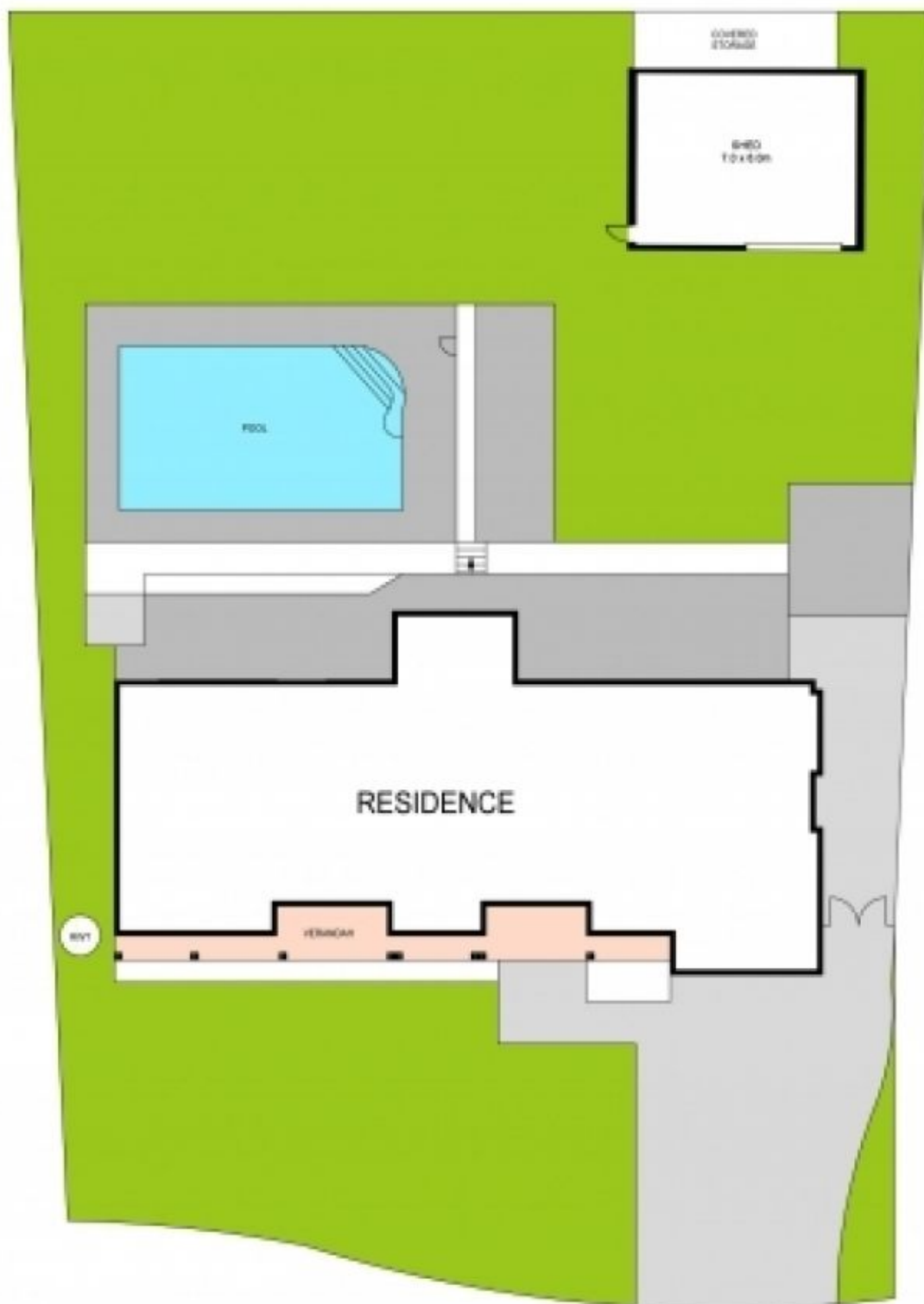

Scale in metres indicative only. Dimensions are approximate. All information contained herein is gathered from sources we believe to be reliable. However we cannot guarantee its accuracy and interested persons should rely on their own enquiries.

5 Ellenborough Drive, Cooranbong

**WILSON**BRITTEN