



## COORANBONG

4  2  2 

Positioned on an idyllic north facing approx. 2.5 acres, this expansive family home offers all the benefits of country living with easy access to town services and major Newcastle to Sydney transport links.

The living areas and the master suite all take advantage of the fantastic valley view, while maintaining the northerly outlook. Its spacious architectural design and atmosphere make this a unique home. Includes features such as ducted air conditioning, sunken lounge area, timber kitchen, combustion fireplace, spacious music room/ home theatre and ground floor workshop.

This is a rare opportunity to secure the lifestyle you have been wanting; a property you will fall in love with and your

[For full version visit the website](https://www.wilsonbritten.com)

**Type** : House  
**Land Size** : 10230 sqm  
**View** : <https://www.wilsonbritten.com/sale/nsw/lake-macquarie-west/cooranbong/residential/home/8474168>



**John Britten**  
0409 681 606



FLOOR PLAN

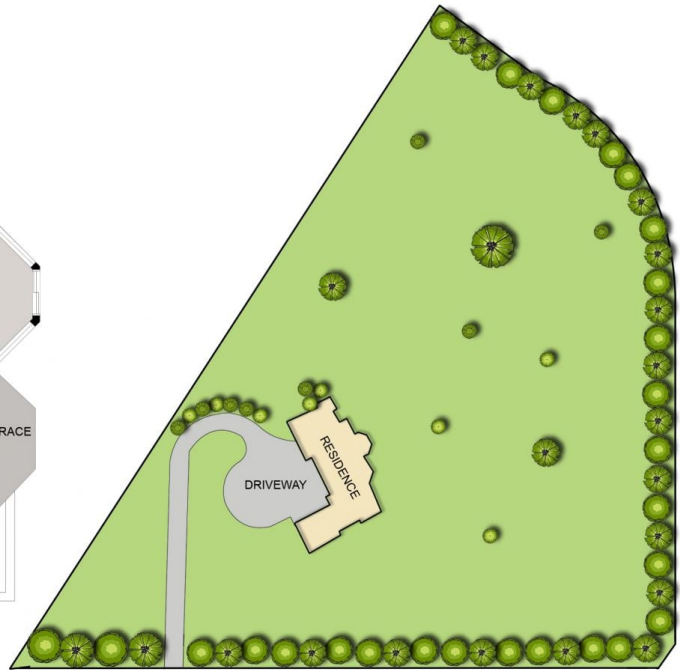

MATTHEWS VALLEY ROAD  
SITE PLAN

This floor plan including furniture, fixture measurements and dimensions are approximate and for illustrative purposes only. Boxbrownie.com gives no guarantee, warranty or representation as to the accuracy and layout. All enquiries must be directed to the agent, vendor or party representing this floor plan.

40 Matthews Valley Rd Cooranbong NSW 2265