



11 Billabourie Road GWANDALAN NSW

4 🛏 2 🚿 2 🚗

Positioned in the popular Central Coast Lakeside suburb of Gwandalan with local primary school at the end of the street, the property is an easy 300m walk to the deep waterways of Lake Macqaurie as well as a substantial boat ramp and public jetty.

- Ideal for anyone looking for dual accommodation or a second income.
- 3-bedroom home with 2 living areas plus a 1-bedroom granny flat
- Supplement the mortgage or dual income for investors
- Fully fenced 651 sq metre block
- Substantial side access ample space for another freestanding double garage
- Extra storage or a workshop, perfect space under the

Type : House
Land Size : 651 sqm
View : <https://www.wilsonbritten.com/sale/nsw/central-coast-region/gwandalan/residential/house/8474239>



Matthew Wilson
02 4970 5545

[For full version visit the website](https://www.wilsonbritten.com)

Internal 159m² External 492m² Total 651m²

11 Billabourie Road, **Gwandalan**



NORTH

3 x 2 x 1 x



HOUSE



STUDIO

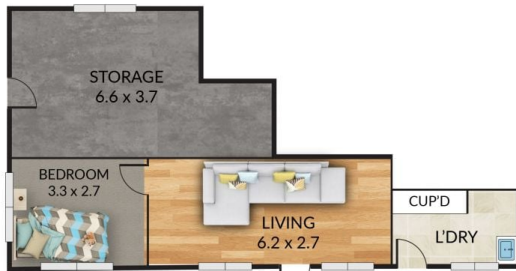

GROUND FLOOR



SITEPLAN

WILSONBRITTEN NOTE: Every precaution has been taken to verify the accuracy of the above details. However, prospective purchasers are advised to make their own enquiries.