



38 Churchill Crescent WINDERMERE PARK NSW

2 1 2

Positioned in a quiet street this attractive 2-bedroom residence is the perfect entry point for those looking for an affordable residence with the added advantage of a detached 2-bay shed.

An easy walk to Bonnells Bay shops as well as the waterfront reserve of Lake Petite, Churchill Cres is a desirable location, with homes in this street rarely coming to the market.

Inside the home you will enjoy open living and dining, separate kitchen, all ready and awaiting your renovation with enough room around the home to allow for a future extension when the time comes. In fact, the 595m² lot allows for off street parking for a caravan and boat still with

Type : House
Land Size : 595 sqm
View : <https://www.wilsonbritten.com/sale/nsw/lake-macquarie-west/windermere-park/residential/house/8474248>



Matthew Wilson
02 4970 5545

[For full version visit the website](https://www.wilsonbritten.com)

Internal 62m² External 37m² Total 99m²

38 Churchill Crescent, **Windermere Park**



2 x 1 x 1 x

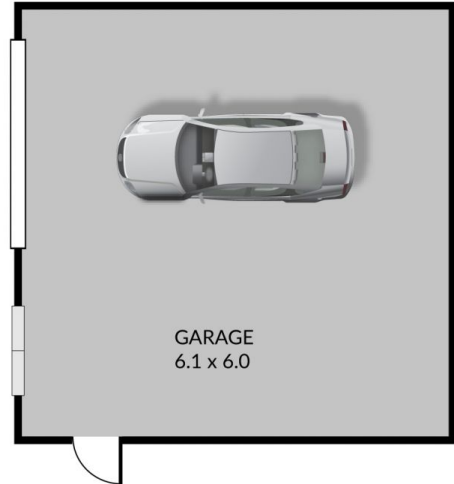
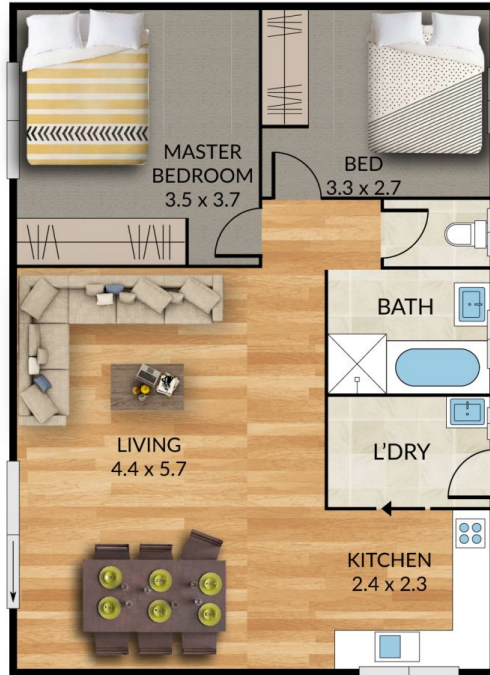

WILSONBRITTEN

NOTE: Every precaution has been taken to verify the accuracy of the above details. However, prospective purchasers are advised to make their own enquiries.