



298B Freemans Drive COORANBONG NSW

Rarely do you see vacant land with such a wide frontage come to the market - but here it is! This 1118m² (approx.) lot is wide and deep and comes with a huge frontage of approx. 26.34m. Dreaming of building one of those grand, ranch-style homesteads? Well, here's your opportunity. The west facing land has a gentle slope towards the picturesque Dora Creek and presents a relaxing and peaceful environment, just a short walk to the creek reserve and easy access to the creek's edge.

Located in the popular town of Cooranbong, known for its ease and convenience to quality schools, public transport, shops and other essential services, five minutes' drive to the M1, just 40 minutes to Newcastle and 50 minutes to Hornsby. An opportunity such as this is a rare occurrence. Call us now on 4970 5545.

[For full version visit the website](https://www.wilsonbritten.com/sale/nsw/lake-macquarie-west/cooranbong/residential/land/8474898)

Type : Land
Land Size : 1118 sqm
View : <https://www.wilsonbritten.com/sale/nsw/lake-macquarie-west/cooranbong/residential/land/8474898>



Tom Gregg
02 4970 5545

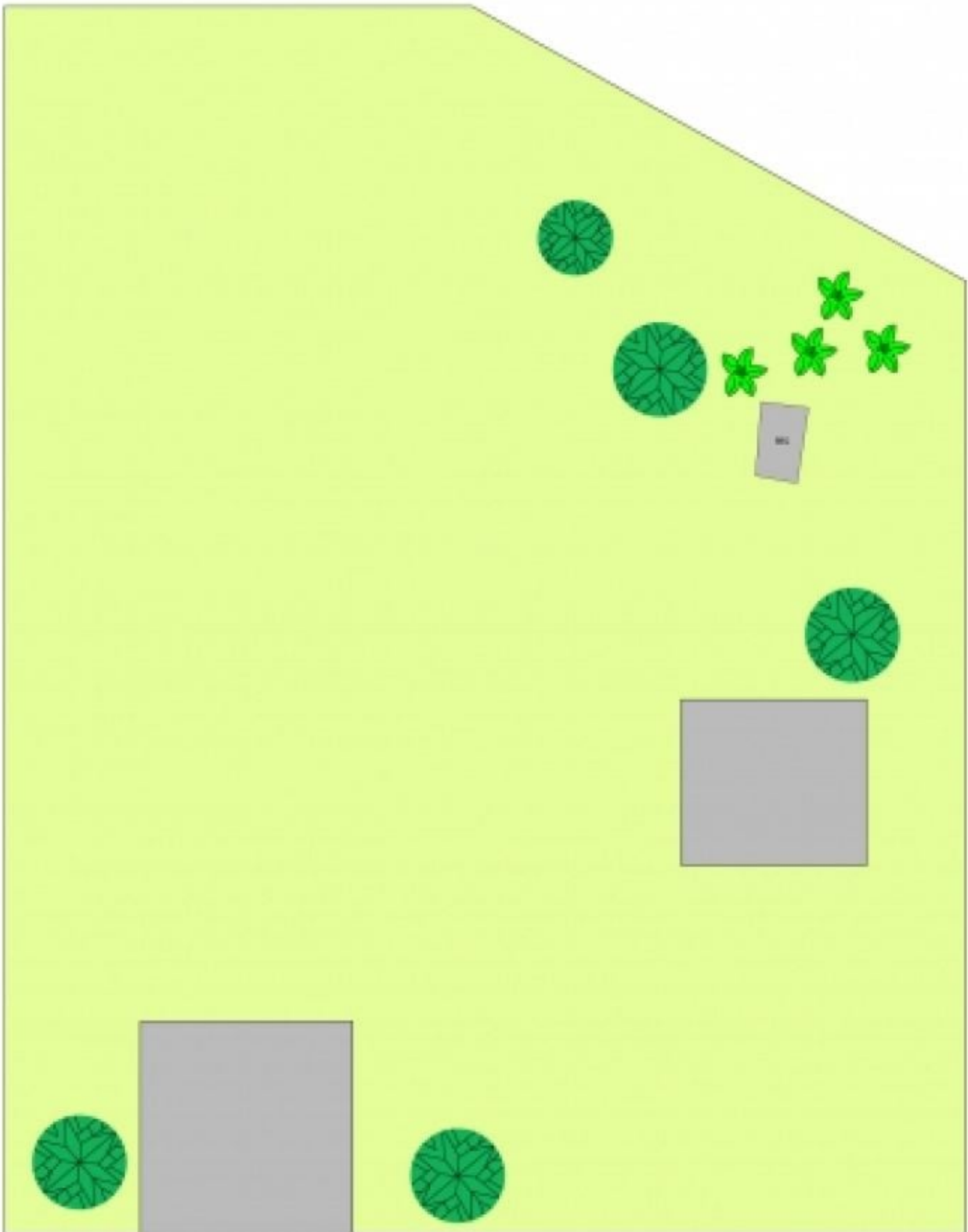

Scale in metres. Indicative only. Dimensions are approximate. All information contained herein is gathered from sources we believe to be reliable. However we cannot guarantee its accuracy and interested persons should rely on their own enquiries.

300 Freemans Drive, Cooranbong